

# Three Phase TEFC Flange Type Induction Motors



## SPECIFICATIONS

TYPE	TTH
PHASE	3φ
OUTPUT	0.2KW~37KW
VOLTAGE	220/380,380 [220,440]V
CYCLE	50HZ, 60HZ
POLES	2P, 4P, 6P
INS. CLASS	B, [F]

\*[ F ] class motor is order made.

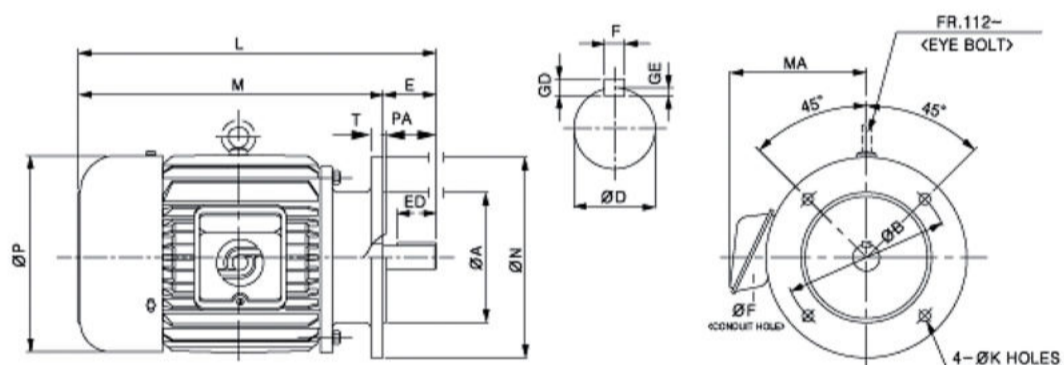

## OUTLINE DIMENSIONS [KSC 4202]

NO	FRAME NO.	OUT PUT(KW)				DRIVE END(P.L)					
		2P	4P	6P	8P	ΦD	F	GD	GE	E	ED
1	71	0.4	0.4			14 <sub>J6</sub>	5	5	3	30	16
2	80	0.75	0.75	0.4	0.2	19 <sub>J6</sub>	6	6	3.5	40	22
3	90L	1.5	1.5	0.75	0.4	24 <sub>J6</sub>	8	7	4	50	28
		2.2									
4	100L		2.2	1.5		28 <sub>J6</sub>	8	7	4	60	40
5	112S	2.2	2.2	1.5	0.75	28 <sub>J6</sub>	8	7	4	60	40
6	112M	3.7	3.7	2.2	1.5						
7	132S	5.5	5.5	3.7	2.2	38 <sub>K6</sub>	10	8	5	80	56
8	132M	7.5	7.5	5.5	3.7						
9	160M		11	7.5	5.5	42 <sub>K6</sub>	12	8	5	110	70
10	160L		15	11	7.5						
11	180M			18.5		48 <sub>K6</sub>	14	8	5.5	110	70
			22	15							
12	180L			18.5		55 <sub>M6</sub>	16	10	6	110	70
			30	22							
13	200L			30		60 <sub>M6</sub>	18	11	7	140	80
			37	37							

NO	FRAME NO.	ΦA	ΦN	ΦB	ΦP	MA	L	M	T	PA	ΦK	ΦF	BEARING		W.T (kg)
													PL	OPL	
1	71	110	160	130	156	138	264	234	10	3	10	22	6203zz	6202zz	13.8
2	80	130	200	165	166	145	289	249	10	3	12	22	6204zz	6203zz	18.5
3	90L	130	200	165	191	160	356	306	12	3	12	21	6205zz	6204zz	20.7
4	100L	180	250	215	191	160	400	340	14	4	15	21	6206zz	6205zz	30
5	112S	180	250	215	237	182	380	320	17	4	15	21	6206zz	6205zz	38.5
6	112M						406	346							45.5
7	132S	230	300	265	269	198	467	387	17	4	15	35	6308zz	6306zz	71.5
8	132M						504	424							83.5
9	160M	250	350	300	308	245	596	486	20	4	19	35	6309zz	6308zz	116
10	160L						640	530							140
11	180M	300	400	350	378	290	653	543	20	5	19	35	6311zz	6310zz	
12	180L	300	400	350	378	290	688	578	20	5	19	35	6312zz	6310zz	
13	200L	350	450	400	410	330	825	685	22	5	19	35	6313zz	6311zz	